

# APARTMENT 6

3 HARRINGTON GARDENS  
SW7 4JJ





## APARTMENT 6

Studio, second floor

This amazing studio apartment has been designed with a chic vibrance to compliment modern city living. The apartment benefits from an abundance of natural light and feels bright and airy.

Guests will enjoy a fully fitted kitchen with high end Sense appliances as well as built-in ceiling speakers, Apple AirPlay technology and high-speed fibre optic broadband. The apartment is approx 300 sq.ft. and is finished with a gorgeous prime oak floor.

The apartment has dedicated house maids who provide partially serviced or fully serviced housekeeping to meet your variable needs.

Free membership to Prana Wellbeing for Pilates, yoga, personal training, massage, and nutrition comes with the apartment

### Location

The property, is located within easy walking distance of Gloucester Road underground station (150m away), with many excellent shops, restaurants, museums and art galleries on the door step.

The area is residential in character and the quick bypass through Hyde Park (which is within troling distance) takes 5-10 minutes to Mayfair. Knightsbridge and Sloane Square are 5 minutes in a taxi. Alongside this, there is easy access to the Cromwell Road with direct links to the M4 and Heathrow Airport.





## Specifications

Beds: One queen-size

Bathrooms: One bathrooms

Maximum occupancy: 2  
300 sq.ft.

Widescreen TV

Blu-ray Player and amplifier

Apple TV & Full Sky TV package

Apple AirPlay and speakers in all rooms

Fiber Optic Broadband and Wifi

Fully fitted kitchen with Sense appliances

White bone china and crystal glassware

Video entry door system

24hr CCTV

In-room safe

Maid service including basic toiletries

TV licence

Council tax

Electricity, gas and water bills

For more information or to arrange a viewing please contact:

1-3 Months:  
+44 (0) 20 7341 5810  
sales@theharrington.com

3 Months +:  
+44 (0) 20 7341 5806  
lettings@theharrington.com

www.theharrington.com

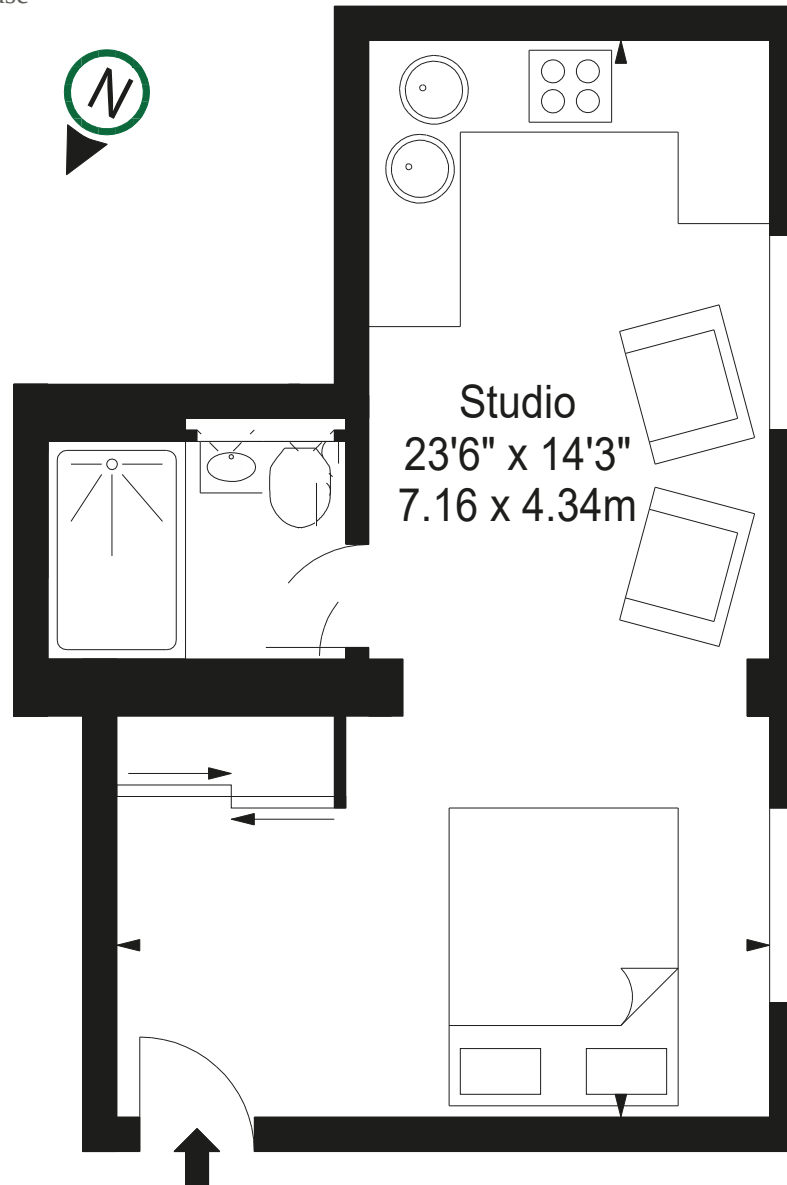
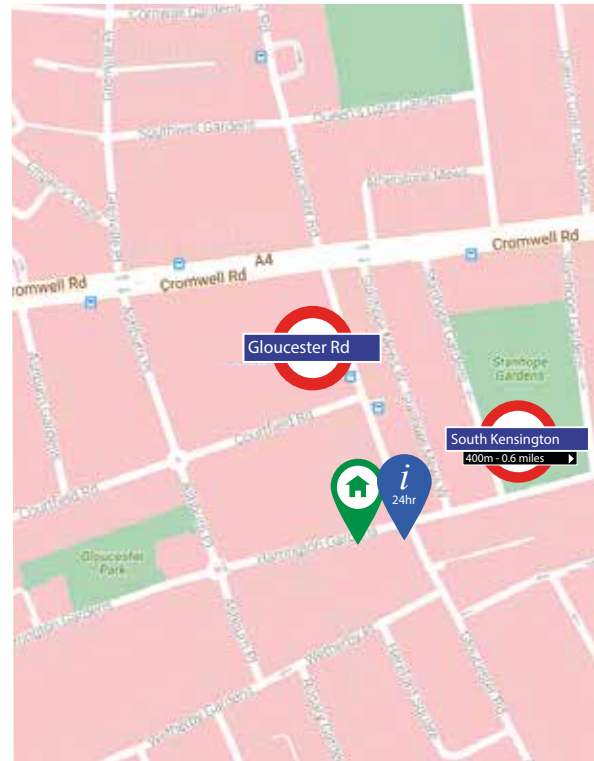
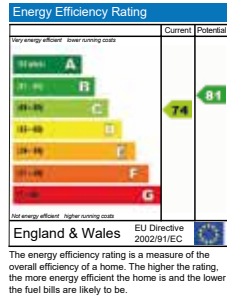

Approx. Gross Internal Area\*  
300 sq.ft. (27.8m<sup>2</sup>)



The Harrington Collection is the proud owner of Prana Wellbeing, located at 1 Harrington Gardens. Prana provides one of the largest Pilates studios in Kensington and Chelsea. It also provides yoga, massage, nutrition and personal training.



On the corner of 1 Harrington Gardens, Calix Restaurant is a pizzeria and grill with a wonderfully warm and friendly atmosphere. With a great choice on their menu, Calix is the perfect alternative to making use of the kitchen within your apartment.